

Dr. Manisha Kumari  
Assistant Professor  
Deptt. of Geography  
S. B. College, Ara

(7)

MARCH '17

APRIL		2017						
Wk	M	T	W	T	F	S	S	
13					1	2		
14	3	4	5	6	7	8	9	
15	10	11	12	13	14	15	16	
16	17	18	19	20	21	22	23	
17	24	25	26	27	28	29	30	

SATURDAY

DAY 084-281 Wk. 12

25

B.A. Part - II  
(Hons.)

Paper - III

Date - 08/05/2024

India (Unit - IV)

\* Types of Rural Settlement  
(Continued)

# Patterns of Rural Settlement

→ Patterns of rural settlement is described as the relationship between one house or building to another.

→ The patterns of rural settlement deals with compact and semi-compact only, as we know that dispersed has its own shape.

→ The socio-cultural factors like caste structure or a functional need of people has a close bearing on its sizes and shapes as we know that rural settlements have different shapes and sizes.

→ The site of the village and surrounding topography and terrain influence the shape and size of a village.

Think like a man of action, act like a man of thought.

- Henri Louis Bergson

17 MARCH

27

MONDAY

Wk 13 DAY 086-279

(8)

MARCH						
Wk	M	T	W	T	F	S
09			1	2	3	4
10	5	6	7	8	9	10
11	11	12	13	14	15	16
12	17	18	19	20	21	22
13	23	24	25	26	27	28

→ The rural settlements are broadly classified under the following patterns :-

(i) Rectangular Pattern

(ii) Linear Pattern

(iii) Circular Pattern

(iv) Star like pattern

(v) Triangular pattern

(vi) Radial Pattern

(vii) Nebular Pattern

(viii) Semi-Circular Pattern

(ix) T-shaped, Y-shaped, Cross shaped.

(i) Rectangular Pattern :- This type of pattern is very common, which develops around the rectangular fields. This type of pattern mainly found in fertile plains like - Gangetic plains etc or wide inter montane valleys.

Failure is the tuition you pay for success.

- Walter Br

APRIL	M	T	W	T	F	S	S
1						1	2
3	4	5	6	7	8	9	
10	11	12	13	14	15	16	
17	18	19	20	21	22	23	
24	25	26	27	28	29	30	

→ The roads are rectangular and also cut each other at right angles.

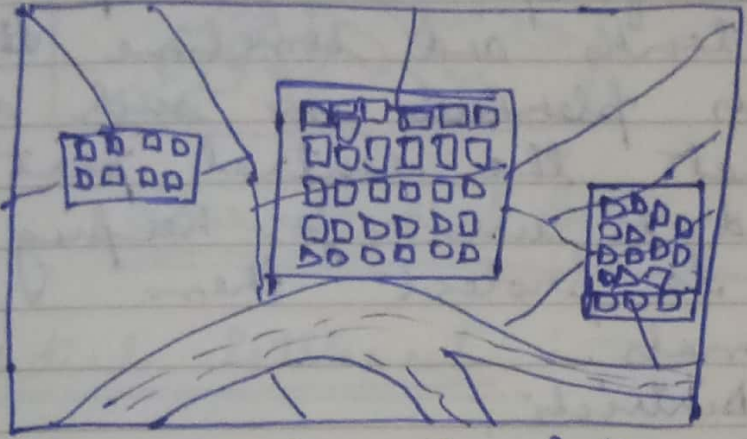

Rectangular Pattern

(ii) Linear Pattern : → In this type of settlements houses are located along a road, railway line, river, canal edge of a valley or along a levee.

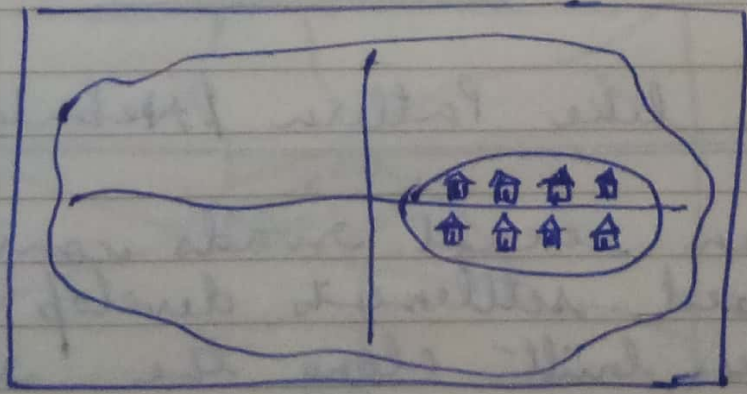

Linear Pattern

shown as a long straight line.

The great end of life is not knowledge but action.

- Thomas H. Huxley

MARCH						
Wk	M	T	W	T	F	S
09			1	2	3	
10	6	7	8	9	10	
11	13	14	15	16	17	
12	20	21	22	23	24	
13	27	28	29	30	31	

29

WEDNESDAY

Wk 13 DAY 088-277

(iii) Circular Pattern :-

→ This type of pattern develop around lake, tanks and sometime the village is planned in such a way that the central part remains open and is used for keeping the animals to protect them from wild animals.

→ Malwa Districts,

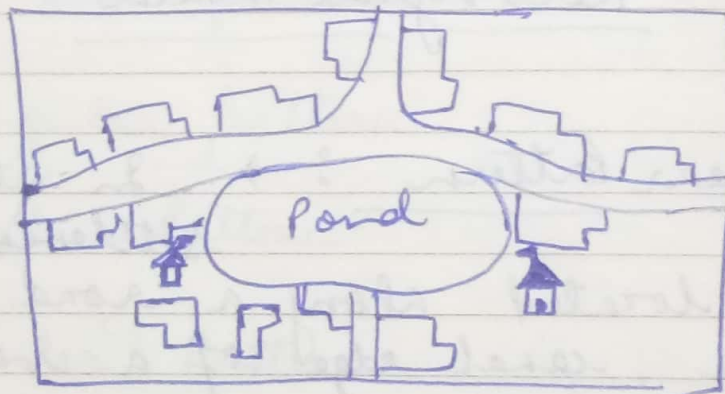

Circular Pattern

(iv) Star like Pattern / Nebular Pattern

→ When several roads converge, star shaped settlements develop by the houses built along the roads.

→ It looks like Star or Nebular.

He was a self-made man who owed his lack of success to nobody.

- Joseph

APRIL							2017	
Wk	M	T	W	T	F	S	S	
13						1	2	
14	3	4	5	6	7	8	9	
15	10	11	12	13	14	15	16	
16	17	18	19	20	21	22	23	
17	24	25	26	27	28	29	30	

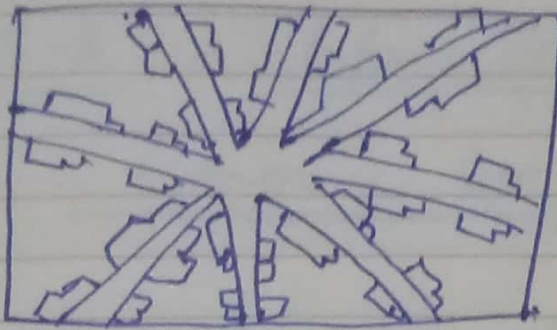

Star Shaped Pattern

(v) Radial Settlement :-

→ It looks like star-shaped settlement.

(vi) Triangular Pattern :-→

- This pattern develops at the confluence of two rivers.
- One village develops on the land lying in between the two rivers.

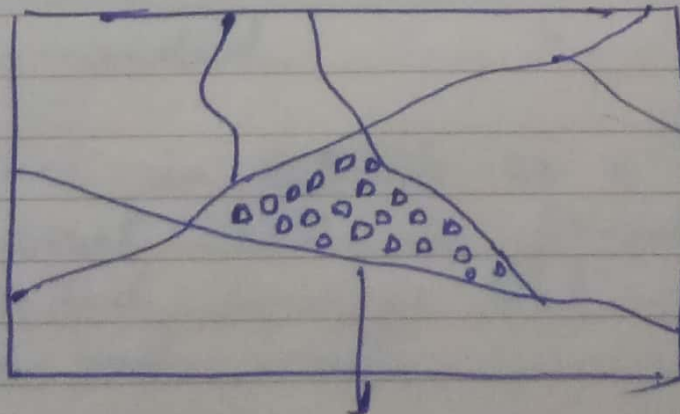

Triangular Pattern